

**Model GF
Digital Glycol
Feeder with
MegaTron XS
Controller**

***Installation
Maintenance
Repair
Manual***

Advantage Controls
P.O. Box 1472
Muskogee, OK 74402
Phone: 800-743-7431
Fax: 888-686-6212
www.advantagecontrols.com

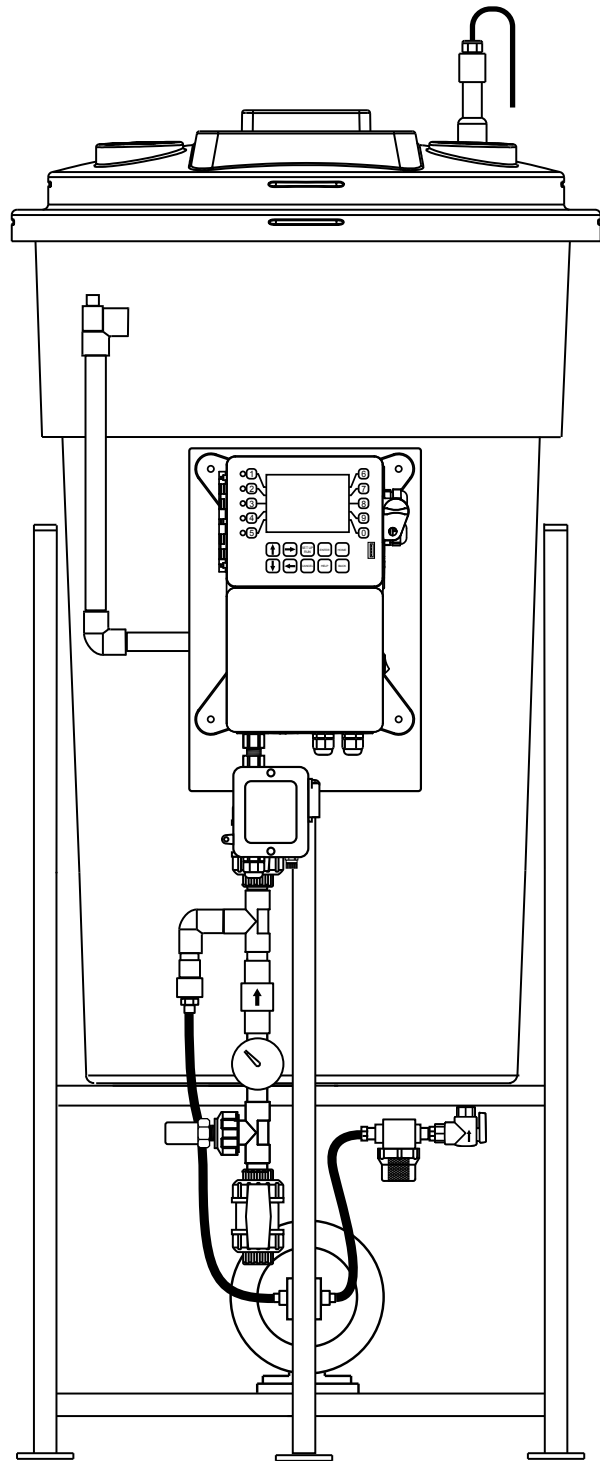

12/2014

Table of Contents

I.	Introduction	2
II.	Model Numbering and General Specifications.....	3
III.	Installation.....	5
	Electrical Wiring	5
	Mounting Instructions	5
	Typical Installation and Measurements	6
	Start Up & Calibration Procedures	7
IV.	Front Panel Description	10
V.	System Operation Overview	11
VI.	Menu Navigation	11
VII.	USB Functions	20
VIII.	Troubleshooting and Maintenance.....	21
IX.	Parts List.....	23
X.	Wiring Diagrams.....	26
XI.	Warranty	28
	Reference Chart % Propylene Glycol.....	29
	Reference Chart % Ethylene Glycol.....	29

I. Introduction

The Advantage Controls Glycol Feed Systems are design to regulate pressure in closed loop Hydronic Heating and Cooling applications.

The Advantage Controls XS Series Glycol Feeders are our advanced design microprocessor based controller with communication options previously unavailable with earlier models.

Standard XS Series Glycol Feeders are built to UL 508 industrial standards and is tested and certified by ETL. With standard outputs of: (2) dry contact relays (one for alarms and our for pump on), (1) timer for agitator control, 20 key data inlay, large multi-line display, audible alarm, motor starter / high amp relay, menu driven program, manual off auto function on all outputs and 4-20mA outputs.

Advantage Controls Glycol Feeders are stand alone pre-wired, pre-plumbed systems designed for ease of installation. Our systems are mounted on a powder coated steel frame with anchor points.

Advantage Controls model designation allows for a wide variety of configurations, operation and function of each Glycol Feed Systems this is dependent on your specific model number. Please check your model number against the selection guide for better understanding of your system.

Please read this instruction manual to become familiar with your system.

II. Model Numbering and General Specifications

BUILD A MODEL

GF - 1 A 1 A 1 G - C1

TANK SELECTION

- 0 = No tank
- 1 = 55 gal (208L) poly
- 2 = 100 gal (378L) poly
- 3 = 30 gal (113L) poly
- 5 = 5 gal (18L) no stand, 30 gpd pump only
- 7 = 150 gallon poly (567L)

STAND SELECTION

- A = Painted steel stand
- B = Painted steel stand w/ mixer bracket
- C = Tank top mount (no tank included)
- D = Portable stand with built in rollers
- E = No stand (for 5 gal tanks)

PUMP SELECTION

*Dual pump sys. require 2 pump selections (i.e., -11)

- 0 = No pump
- 1 = 1.5 gpm at 100 PSI; 1/3 hp
- 2 = 3.3 gpm at 100 PSI; 1/2 hp
- 3 = 6.1 gpm at 60 PSI; 1/3 hp
- 4 = 9.9 gpm at 60 PSI; 1/2 hp
- 5 = 30 gpd at 100 PSI; solenoid driven

PUMP CONFIGURATION

- A = Standard configuration
- B = Alternating pumps for single loops (requires 2 pump selections)
- C = Pump plumbed for transfer duty into tank

LOOP SELECTION

*Dual loop sys. require 2 loop selections (i.e., -11)

- 0 = No loop
- 1 = Sch 80 PVC loop; 100 PSI max; 100°F max
- 2 = Copper loop; 100 PSI max; 180°F max
- 3 = Carbon steel loop; 100 PSI max

CONTROL SELECTION

- D = Pre-configured XS Series controller prewired to match existing single / dual pump system. Mounted to replacement panel with (1) audible alarm and system matching high amp / relay box(es)
- G = Pre-configured ETL listed XS Series controller prewired for a single pump system.
- H = Pre-configured ETL listed XS Series controller prewired for a dual pump system.

OPTIONS

- 1 = 240V
- 3 = Solenoid valve for pressure relief
- 5 = Position backcheck to use tank for expansion
- C1 = Communications card **Internet** *
- C11 = Communications card **Modbus** *
- C12 = Communications card **BacNet** *
- G = PUMP ON - dry contact relay
- H = 1/4" PVC pipe instead of pump suction tubing
- M = Mixer controls (order mixer separate)
- O4= Four 4-20mA outputs *

* Options C1, C11, C12, O4 require control option D, G or H.

Specifications

Electrical

- Input 120 VAC, 60 Hz
- Alarm Dry Contact
- Motor: 1/3 HP Pump: 1.5 GPM

Plumbing

- Standard Schedule 80 PVC
- Optional Copper or Black Iron

Enclosure

Heavy Duty NEMA 4X style, high impact thermoplastic with padlockable gasketed Lexan viewing door

Pressure Gauge 0-100 psi (0-6.9 bar)

Dimensions

- W 27.5" (69.8 cm)
- H 64" (162.5 cm)
- D 31.5" (80 cm)

Shipping Weight

330 lbs (149.69 kg) approx.

Most units include poly tank and stand, low level switch with audible alarm (100db), motor starter / high amp relay, dry contact alarm, pressure relief valve and plumbing assembly with pressure gauge and sensor.

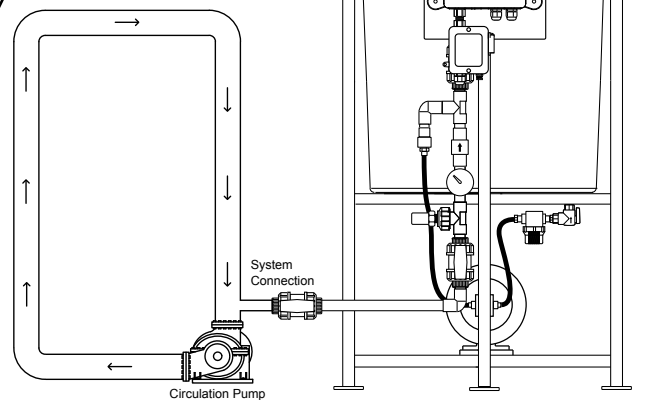

Base Functions

MegaTronXS units have several base system control functions and unit optional features. Your unit may be supplied with one or more of the features described in this manual. To determine what features apply to your unit check the model number label located on the controller enclosure.

Base System Control Functions

F1 - (1) Timer Standard

Whole Unit Optional Features

A - Conduit Connections

C1 - Communications card **Internet**

C11 - Communications card **Modbus**

C12 - Communications card **BacNet**

Model numbers start **XS** followed by the System Control functions. A **dash** separates the whole unit options listed after all base system control functions. Example: **XSCPF3E-N4**.

Notice: Your unit may not have all features and functions described in this manual. This list represents our most popular options, additional option codes are available.

Description of Unit

MegaTronXS controllers control a single recirculating water system including closed loop applications and may have various features depending on the model number.

Standard Timer

The standard timer is designed to automate a mixer action activating a relay output. This timer can be programmed to be one of the following types.

- *1. **Pulse Time** - Accepts pulses from a make-up water meter (supplied separately). It can accumulate 1-9999 gallons before activating the timer to run.
- *2. **Feed with Bleed** - Activates the relay output simultaneously with the bleed and limits the amount of time the relay output will be on during the bleed cycle.
- *3. **Feed after Bleed** - Activates the relay output based on a user defined percentage of time based on the bleed off, another timer or digital input. The relay is activated after a bleed cycle and runs for the set percentage of that bleed cycle.
4. **Recycle** - The relay is continuously repeating a defined OFF cycle time and a user defined ON cycle time.
5. **28 Day** - The timer is based on a 28 day cycle with four independent programmable feed cycles with prebleed and bleed lockout settings.

* Note: These functions are for application other than glycol feeders.

III. Installation

Electrical Wiring

The MegaTron XS series digital glycol feeder controller has an internal regulated power supply that will operate in the range of approximately 90 to 250 VAC at 47 to 63 Hz on the incoming wiring. Output relay(s) are protected with a replaceable fuse. Each relay's output voltage will equal incoming line voltage. The Standard prewired units are supplied with a 8 foot, 16 AWG, 3 wire grounded, 120 VAC USA power cord for incoming power.

NOTE: Liquid tight fittings and labeled signal lead cables are provided for all signal (low voltage) connections, low drum level and pressure transducer.



WARNINGS:

- 1. The controller should be connected to its own isolated circuit breaker, and for best results, the ground should be a true earth ground, not shared. Wiring must be done according to all applicable local codes.**
- 2. Power (line voltage) must be disconnected while making any connections. If power is supplied to the unit, line voltage will be present on the relay cards.**
- 3. Low voltage signal wires (transducer, level, alarm, etc.) should never be run in conduit with high voltage wires.**

Mounting Instructions

Select a mounting location that provides the operator easy access to the unit and a clear view of the controller. The location should be convenient to grounded electrical connections and system plumbing connections. Mount the glycol feeder stand to a level concrete pad using the ½" mounting holes in the base of the stand. Concrete pad construction and anchoring bolts must comply with local building codes. The required sample line plumbing should be connected to the return header of the Hydronic system



WARNING:

Avoid locations that expose the controller to direct sunlight, vapors, vibration, liquid spills or extreme temperatures; less than 0°F (-17.8°C) or greater than 120°F (50°C). EMI(electromagnetic interference) from radio transmissions and electric motors can also cause damage or interference and should be avoided.

Typical Installation and Measurements

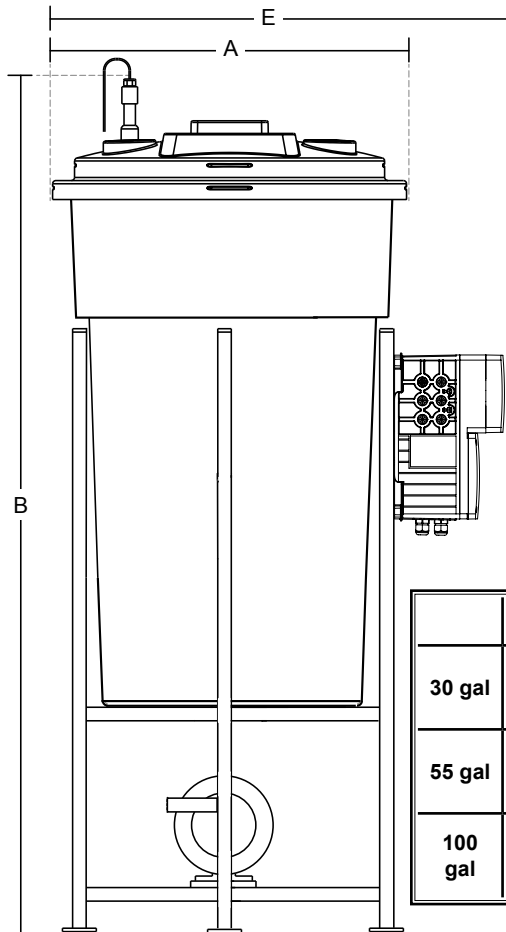
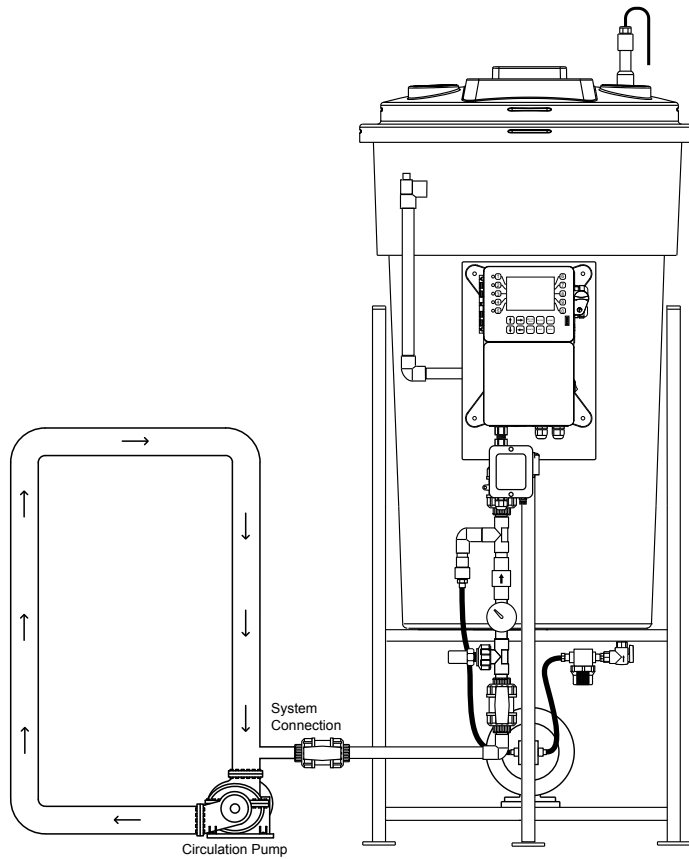

Side View Shown

GLYCOL STAND FOOT PRINT

1/4" bolt hole drilled
3/4" from outside edge

Note: This is for mounting
holes only. Controller will
extend beyond this depth.

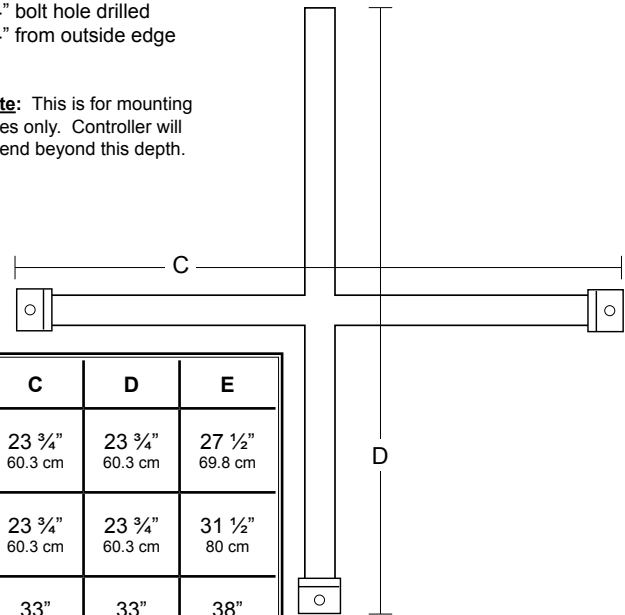

	A	B	C	D	E
30 gal	23 3/4" 60.3 cm	49" 124.4 cm	23 3/4" 60.3 cm	23 3/4" 60.3 cm	27 1/2" 69.8 cm
55 gal	27 1/2" 69.8 cm	64" 162.5 cm	23 3/4" 60.3 cm	23 3/4" 60.3 cm	31 1/2" 80 cm
100 gal	31 1/4" 79.3 cm	66" 167.6 cm	33" 83.8 cm	33" 83.8 cm	38" 96.5 cm

Glycol Feeder Start-Up Procedure

Complete all installation steps before beginning this procedure. Ensure that all controlled devices (pumps, solenoid valves, etc.) are operational and connected to the controller.



WARNINGS:

Before applying power to the controller, remove the fuse(s) from the fuse holder(s) located on the high amp relay extension. There will be two (2) fuses on dual pump system. Reasoning behind this is, factory settings may not agree with your system and this gives time for you to set your parameters before applying power to the pump or pumps.

1. Before filling tank, be sure that the tank and the filter bowl are free of packing material and or construction debris.
2. Check plumbing as it may have become loose from vibrations during shipping.
3. Fill Tank
4. Open the valve closest to the drain port of the plumbing assembly by turning the handle clockwise. Water will pass through the sample stream assembly.
5. Ensure that the system pressure does not exceed 100 psi.
6. Check all fittings of the plumbing assembly for leaks. If there are no leaks verify that the pressure gauge agrees with system pressure. This value may vary do to connection to Hydronic systems placement.
7. Apply power to your system to check configuration of the pressure setpoint.
8. Once you are familiar with the controller from either reading the instruction manual or trial and error, proceed with setting perimeters that are correct for your hydronic system.
9. Power off the controller, insert the fuse(s) into the fuse holder(s) located on the high amp relay extension.
10. Power ON the control to verify proper operation.

Pressure Relief Configuration Procedure

1. Pressure relief values are set at 75 psi by default from the factory.
2. To increase the psi, spin the valve clockwise.
3. To decrease the psi, spin the valve counter clockwise.
4. Close drain port valve slowly to raise system pressure to the relief level.
5. Open drain port valve to relieve system pressure and conclude test.

Alarm Buzzer Disable and Enable Procedure

1. Press the 0 key at the home screen to enter into the relay status screen.
2. Press the 2 key twice after entering into the relay status screen to disable the alarm buzzer.
3. Press the 2 key once more to set the relay back to the normally pressure automated state.
4. Press the 2 key once more to force the alarm buzzer relay ON.

Pressure Setpoint Configuration Procedure

If these are improperly set by entering an A/D value for the settings while the input is not seeing the correct signal a signal generator will be required to reset the calibration.

Step 1:

Push the **HOME** button to leave Calibration and go back to the HOME menu screen. From here push **SETPOINTS** (Button 1) to go to the next screen

```
>HOME SETUP<
SETPOINTS          DATE/TIME
CALIBRATION        CONFIGURE
TIMERS              HISTORY
CUSTOMIZE           TOTALIZERS
ALARMS              RELAYS
```

Step 2:

This is the Setpoints Setup Screen. From here push **mA IN** (Button 7) to go to the next screen

```
>SETPOINTS SETUP<
SENSORS
mA IN
```

Step 3:

This is the mA Inputs Screen. From here push **INPUT 1** (Button 1) to go to the next screen

```
>mA INPUTS<
INPUT 1
```

Step 4:

This is the mA Input 1 Setpoint Review Screen. From here push **SETPOINTS** (Button 5) to go to the next screen

```
>mA INPUT 1 SETPOINT<
  mAIN1
SET POINT:    500%
              RISING CONTROL
DIFFERENTIAL: 20
HIGH ALARM AT: 1000(OFF )
LOW ALARM AT: 0(OFF )
LIMIT TIME:  00:01 HH:MM
SETPOINTS
```

Step 5:

This is the mA Input 1 Setpoint Change Screen. From here you can set **SET POINT** (Button 1), **DIFFERENTIAL** (Button 2), **HIGH ALARM** (Button 3), **LOW ALARM** (Button 4) and **LIMIT TIME** (Button 5). Press the desired button to go to the next screen

```
>mA INPUT 1 SETPOINT CHANGE<
SET POINT
DIFFERENTIAL
HIGH ALARM
LOW ALARM
LIMIT TIME
```

Step 6:

Set the value of **SET POINT** by using the number keys. Use the left arrow to set the reaction direction of the set point between **RISING** or **FALLING**. Then press **ENTER** to confirm and go to the previous screen

```
>mA INPUT 1 SETPOINT CHANGE<
SET POINT (RISES TO 00500 %)
[RISES][__ ] %
USE NUMBER KEYS TO CHANGE, PRESS
ENTER TO ACCEPT OR BACK TO ERASE
LIMIT TIME
```

Step 7:

Set the value of **DIFFERENTIAL** by using the number keys. Then press **ENTER** to confirm and go to the previous screen

```
>mA INPUT 1 SETPOINT CHANGE<
DIFFERENTIAL 00020 %)
[__ ] %
USE NUMBER KEYS TO CHANGE, PRESS
ENTER TO ACCEPT OR BACK TO ERASE
LIMIT TIME
```

Step 8:

Set the **HIGH ALARM** settings for **VALUE** (the reading that will give a High Alarm) and **NOTIFICATION**. Press **ENTER** to confirm and go to the previous page

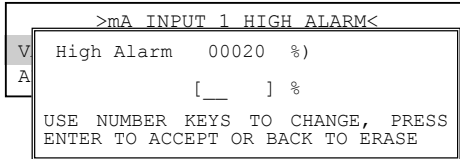

Step 9:

Set the value of the **ALARM NOTIFY** by using the arrow keys. Then press **ENTER** to confirm and go to the previous screen.

Note: Display - will appear on controller display only, Remote - appears through email if controller is online, or both Dis/Remote

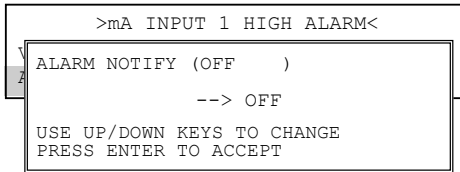

Step 10:

Repeat Steps 19 and 20 for the **LOW ALARM**. Press **BACK** to return the mA Input 1 Set Points

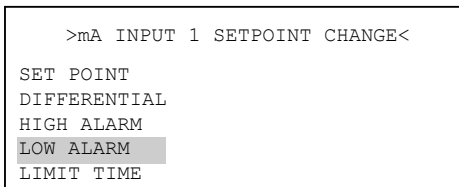

Step 11:

Set the value of **LIMIT TIME** by using the number keys. Then press **ENTER** to confirm and go to the previous screen. The Limit Time and the Alarm Notification will need to be set. Press **HOME** when finished to return to the **HOME** menu

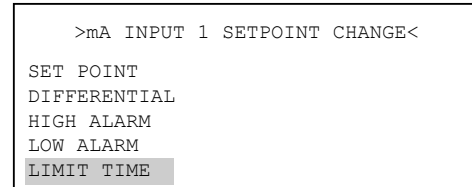

Note: If the Limit Time is met a relay activated by the 4-20mA input will be forced off until the Set Point has been satisfied and reset.

IV. Front Panel Description

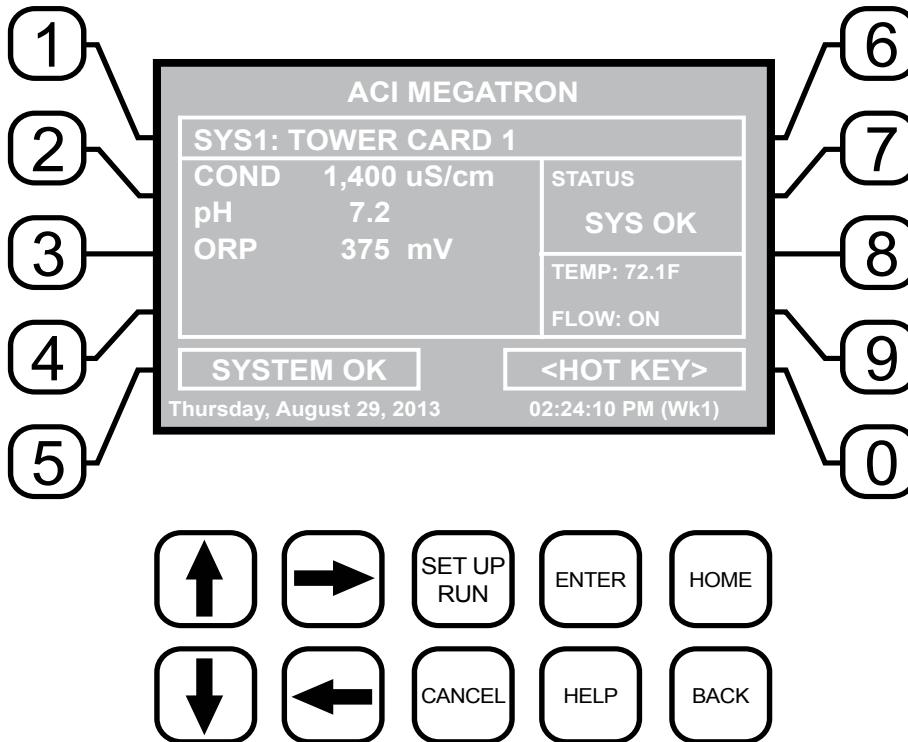

- NUMBER Keys- Used to enter new values in the SET UP mode and to access desired sub menus.
- UP/DOWN - Used to cycle through text options to find desired setting.
- LEFT/RIGHT - Used to cycle through text or setting options to find desired setting.
- SET UP/RUN - System initializes into RUN mode. Press this key to put the controller in SET UP Mode and see HOME menu page.
- ENTER - Used to log a changed value into program.
- HOME - Used to go back to the HOME menu page.
- CANCEL - Used to cancel a pop-up screen if no change is desired.
- HELP - Used to access help screens.
- BACK - Used to go back to last menu screen viewed or clear values keyed in that are not wanted.

The bottom right box in the RUN screen mode is a hot key that will take you directly to a particular menu screen. The default is the RELAY status menu but this can be changed by navigating to the desired screen and pressing the HELP button. Follow the on-screen instructions to set the new hot key location.

V. System Operation Overview

Operation

MegaTronXS controllers have two modes of operation, RUN and SET-UP.

RUN - This mode is for normal operation. In the RUN mode the display will show each system's parameters. If an alarm is present, the ALARM box will flash how many alarms are activated. No settings may be entered or changed in the RUN mode. Readings are updated every 6 seconds on the screen while in the RUN mode.

SET-UP - This mode is used to make adjustments to settings and readings on the controller. To access the SET UP mode from the RUN screen, press the SETUP/RUN key.

VI. Menu Navigation

To access the menus press the Set Up / Run key on the front panel. This takes you to the Home menu. MegaTronXS controller's menus are easily navigated by pressing the associated number key next to a menu box on the screen. Once you have stepped through the sub menus to reach a point at which a value or selection is made a Pop-up window will appear prompting you to enter a desired value or selection.

NOTE: When entering new numeric values, enter all available digits (characters).

1. Home Menu

>HOME SETUP<	
SETPOINTS	DATE/TIME
CALIBRATION	CONFIGURE
TIMERS	HISTORY
CUSTOMIZE	WATER METER
ALARMS	RELAYS

From the **HOME** menu select the desired menu. The menu name explains what parameters can be programmed in the menu.

SET POINTS -	Setting control set points for pressure.
CALIBRATION -	Calibrating pressure.
TIMERS -	Menu for selecting type and settings for all present feed timers.
CUSTOMIZE -	Giving the controller, each system and all relays a user defined name.
ALARMS -	View current alarms.
DAY/TIME -	Menu for setting date and time.
CONFIGURE -	Menus for configuring passwords, relay activations, setting history interval, flow switch, contrast, temperature scale.
HISTORY -	Allows for view history on board in a graph form.
WATER METER -	Menu for configuring water meter totalizing.
RELAYS -	Menu for resetting accumulated "ON" times and manual relay activation.

2. Set Points

The same basic format is used for defining each available analog probe input's control parameters..

```
>SYSTEM 1 SET POINTS<
                                     mA OUT
                                     mA IN
                                     AUX INPUTS
```

SET POINTS - For setting the relay set points for the available analog probe readings such as 4-20 mA inputs for pressure.

NOTE: In the Setpoints pop-up screen the direction (Rising or Falling) of the setpoint can also be set. If the setpoint is configured for 'Rising' the pump output relay will activate when the PSI reading exceeds the setpoint. The pump output relay will remain activated until the PSI reading falls below the setpoint by the amount of the differential. If the setpoint is configured for 'Falling' the pump output relay will activate when the PSI reading falls below the setpoint. The pump output relay will remain activated until the PSI reading rises above the setpoint by the amount of the differential.

2.5 Aux Inputs

Auxiliary inputs are the digital inputs for optional Flow Switch and other digital inputs such as low drum level alarms. From these menus the user can set if they want each of the alarms Displayed, Remote Notification, both or none.

```
>SYSTEM 1 DIGITAL INPUTS ALARM<
ALARM NOTIFICATION      DIGITAL 1
FLOW SW = DISPLAY       DIGITAL 2
DIGITAL 1 = DISPLAY     DIGITAL 3
                        DIGITAL 4
FLOW ALARM              DIGITAL 5
```

Note: Digital inputs can have the direction selected between OPEN or CLOSED as the alarm polarity. If set for CLOSED the input will be in alarm when it sees a closed contact.

2.6 4-20mA Out

Units with a 4-20mA output option will have a menu for setting up the 4-20mA output. The 4mA and 20mA values can be defined by giving the output proportioning capability. i.e. 4mA = 0.0 PSI and 20mA = 100.0 PSI.

```
>OUT 1 SETUP<
SIGNAL SOURCE
4mA VALUE
20mA VALUE
```

SIGNAL SOURCE - Select which probe reading the mA will use as its reading source.

4 mA VALUE - What the 4mA signal equals

20mA VALUE - What the 20mA signal equals on the assigned signal sources scale.

2.7 4-20mA Input

```
>mA INPUT 1 SETPOINT<
SET POINT
DIFFERENTIAL
HIGH ALARM
LOW ALARM
```

SET POINT - What reading turns the relay on

DIFFERENTIAL - Amount reading changes by before the relay is turned off (min. 5 PSI diff. recommended).

HIGH ALARM - What reading generates a High alarm notification.

LOW ALARM - What reading generates a Low alarm notification.

3. Calibration

Calibration is for adjusting the displayed value of a probes reading to match your tester or known solution. Pick the system or mA input first. From a particular system pick the probe to calibrate.

All MegaTronXS controllers are factory calibrated. All units are shipped with the date preset, and the clock set to your current time. These readings and settings should be verified for accuracy, and adjusted as per the instructions listed below.

3.3 4-20mA Output Calibration

```
>CURRENT LOOP CALIBRATION<
OUTPUT 1
OUTPUT 2
```

4-20mA outputs can be calibrated to insure that the output generated by the controller and received by the external device match. With a volt meter connected across the out and return wires (see page 24) of the 4-20mA output channel to be calibrated go into the output's Low or High calibration.

```
>mA OUTPUT 1 CALIBRATION<
HIGH 4030
LOW 800
```

The number displayed in the Calibration dialog box can range from 0-4095 with 800 equal to 0 mA output and 4030 equal to 20 mA. This number range of 0-4095 is the raw digital to analog (D/A) values and is strictly used for a reference. The D / A numbers you get will vary based on your installation conditions.

```
>mA OUTPUT 1 CALIBRATION<
OUTPUT 1 CAL HIGH
4000
Use Up/Down arrows to change
Use Enter to save value
```

While in the High or Low calibration pop-up screen use the up and down arrows to change the output value being read with the volt meter. Adjust the High value for the 20 mA reading and the Low value for the 4 mA value.

3.4 4-20mA Input Calibration

4-20mA inputs can be calibrated to insure that the input seen by the controller from the external device match. It also allows for setting the 4-20mA input into a number range that relates to the value being read.

```
>CURRENT LOOP CALIBRATION<
INPUT 1
INPUT 2
```

Select the Input to be calibrated

```
>mA INPUT 1 CALIBRATION<
20mA          5500
4mA           1100
MAX            200
LOW            0
OFFSET        FACTORY DEF.
```

The 20mA and 4mA values are where the controller's raw analog to digital value is adjusted to match a 20mA (full scale) and 4mA (bottom of scale) signal from the external device inputting the 4-20mA input. The external device must be connected to the controller and showing either full scale or bottom of scale when calibrating each. The number shown along with either the 20mA or 4mA while calibrating is the raw A/D value and is only

a reference. A 20mA input should be around 5500 and 4mA around 1100. If the A/D numbers are not in this range check input device.

The MAX and LOW calibration inputs are for telling the controller what to display for a 20mA input and a 4mA input. For example if the input is a drum level sensor monitoring a 55 gallon drum the value for MAX should be 55 and LOW should be 0. The controller then displays a number automatically ranging between 55 and 0 based on the input value. The units of measure (gallons for example) is set in the Customize menu from the Home page.

OFFSET - Changes the current displayed value of the 4-20mA input reading to allow for a manual 1pt calibration of the displayed value.

FACTORY DEFAULT - If the 20mA or 4mA calibration has been incorrectly set (not at 4 or 20) this will reset the settings back to a factory value for 4 and 20.

4. Timer

A unit may have up to (1) timer standard for each system on a controller. All timers are associated with their system, so for a % of post bleed timer looks at the bleed of that system.

```
>SYSTEM 1 TIMER<
TIMER 1
```

TIMER - Select the type (28-day, pulse, limit, percent or percent of post blowdown) as well as the run times of each timer available per system.

4.1 Timer Type Selection

A pop-up screen lets you scroll through the various timer types available.

```
>SYSTEM 1 TIMER 1 SET UP<
>SET TIMER TYPE (PULSE)<
-> PULSE
USE UP/DOWN KEYS TO CHANGE
PRESS ENTER TO ACCEPT
SET UP          TIMER TYPE
```

- * **Pulse** - A water meter activated timer
- * **Limit** - Feed with bleed with a maximum run time or limit for one bleed cycle.
- * **Recycle** - A continuous recycle timer with ON and OFF settings.
- * **Percent Post Bleed** - For feed after bleed for a settable percentage of the bleed time with a maximum run time.
- * **28-Day** - A biocide or event timer.

* Main timer types used

4.2 Timer Set Up

```
>SYSTEM 1 TIMER 1 SET UP<
TIMER TYPE: PULSE
              GALLONS: 10
RUN TIME     (MM:SS): 01:00
INPUT:       WATER METER 1
SET UP          TIMER TYPE
```

Each timer type selected will have its own unique Set Up sub menu with additional selections specific to the type of timer selected. The page displayed before entering the Set Up menu of a timer provides an overall review of the timers current settings.

4.3 Recycle Timer

```
>SYSTEM 1 TIMER 1 CHANGE<
ON CYCLE (HH:MM)
OFF CYCLE (HH:MM)
OFF TIMER (HH:MM:SS) : 0:10:40
```

ON CYCLE - The amount of the defined time that the timer is to be on.

OFF CYCLE - The amount of time that the cycle is going to be on.

ON/OFF TIMER - This is the displayed count down of time for the cycle the timer is in.

4.7 28-Day Timer

Each 28-day timer has Program 1-4 for programming the various feed times. While the programming steps for four programs are the same each can have it's own independent settings.

```
>SYSTEM 1 TIMER 1 CHANGE<
WEEKS
DAYS FEED LOCK
START TIME
RUN TIME FLOW LOCK
```

WEEKS - The week(s) that the timer is to feed.

DAYS - The day(s) that the timer is to feed.

START - The time of day for the timer to start.

RUN - How long the timer is to run.

FEED LOCK - Which other system timer to lockout during this timer's run time.

FLOW LOCK - If the system has a flow switch you can ignore it for this timer.

5. Customize

This menu allows the user to define the on-screen name of the unit plus the name of each system and relay. The user can also setup the Notepad for each system and 4-20mA Input's name and unit of measurement.

```
>CUSTOMIZE<
UNIT NAMES
RELAY NAMES NOTEPAD
SYSTEM 1 NAME pH INDEX
mA IN
RUN SCREEN
```

RUN SCREEN - Allows the user to select what will be shown on the screen while the controller is in the RUN mode. Like displaying temperature readings, water meter totals for a particular system or the conductivity units of measure.

NOTE: When entering values for custom names use the numerical keys for numbers and the up / down arrows to scroll through all the characters of a key board. Press the right arrow to advance the cursor after setting a desired value. Press the Help button to place the last entered character into the new cursor space to speed up the process. The Help button will also jump advance through the characters.

5.1 Notepad

The Notepad function allows the user to set up a customized manually entered data field for each system with ten notepad items. The NOTEPAD is ideal for setting up and storing into the controller's history the items typically tested for reporting a service call. The Notepad items come with no names but when an individual note is selected a menu for setting it appears.

Also can be used as a Reminder Timer with or without flow.

>NOTEPAD SYS 1 NOTE 1<

NAME
NUMBER
UNITS
ALARMS

NAME - Pick from a list of defined names or customize your own.
NUMBER - Set the number range.
UNITS - Set the units of measurement.
ALARMS - Set Hi/Low alarm points and how frequently a new value is expected to be manually enter via the History menu.

5.2 mA Inputs

>mA INPUT 1 CUSTOMIZE<

NAME
UNITS
NUMBER

NAME - Name the input.
UNITS - Set the units of measurement.
NUMBER - Set the number range.

5.4 Run Screen

This lets you customize various aspects of the RUN screen.

>RUN SCREEN<

MAIN SCREEN
SCREENS SHOWN
CYCLE TIME
COND UNITS

MAIN SCREEN - Customize what is displayed on the RUN screen.
SCREENS SHOWN - Pick if the mA input & Aux Flow screens are scrolled.
CYCLE TIME - The amount of time between screen scrolls.
COND UNITS - Select the units of measure to be displayed with the conductivity reading.

6. Alarms

>ALARMS<

SYS 1 ALARMS

ALARMS - Shows any current alarms.

7. Date and Time Set Up

>SET DATE AND TIMES<

SET DATE
SET TIME
SET DAY
SET WEEK
Friday May 14, 2005 03:04:56

DATE AND TIME - For setting the date, time, day and week on the controller.

8. Configure

Provides access to menus to set-up passwords, relay activation, temp scale, display contrast, flow switch, inputs, history time stamps, factory set-up and system information.

>CONFIGURE<	
PASSWORD	CONTRAST
RELAYS	TEMP SCALE
	NETWORK
HISTORY	SYS INFO
FLOW SW	FACTORY

CONTRAST - This screen allows for adjusting the display contrast.

FLOW SW - Defines a flow switch to be open or closed with flow.

FACTORY - A factory only menu

TEMP SCALE - Set Celsius or Fahrenheit

HISTORY - Sets the history time stamp interval.

SYS INFO - Tells unit software specifics.

8.1 Password

>CONFIGURE PASSWORDS<	
ADMIN PASSWORD	
USER PASSWORD	
USER SET UP	

ADMIN PASSWORD - The administrator password gives access to all menus except factory set up.

USER PASSWORD - The user password allows the user to access HOME menus that are made available in USER SET UP.

8.2 Relays (factory pre-configured)

>RELAY 1 SETUP<	
MAIN ACTION	DISABLE 1
ACTIVATOR 2	DISABLE 2
ACTIVATOR 3	DISABLE 3
ACTIVATOR 4	DISABLE 4
DELAY	DAILY MAX

CONFIGURE RELAYS - This menu lets you choose a **Main Action** or function (timer 1, conductivity, alarms etc...) to activates a relay.

A pop-up screen appears with a list of all available activation functions to arrow through.

Additional relay logic is available with up to 3 additional **Activators** and up to 4 **Disablers** allowing multiple functions to activate the same relay and multiple functions to prevent the relay from coming on. There is also a Daily Max amount of time that a relay can be on. If a relay is on for the max amount it does not let the relay come on anymore that day. (A 24 hour clock is used for the day with midnight being the start of the day). The Delay setting is the amount of time a control function must come on before the relay will react and activate. This is to prevent a relay from chattering on/off if a reading is bouncing around the set point or alarm.

8.3 History

This menu is used to set the history "time stamp" interval, the water meter daily history starting hour and the alarm delay period.

>CONFIGURE HISTORY<	
INTERVAL	
W/M HOUR	
ALARM DELAY	

INTERVAL - The amount of time between each history time stamp for probe readings.

W/M HOUR - The time of day that the daily water meter history cycle is to start.

ALARM DELAY - The amount of time an alarm has to be on before it is recognized as an alarm.

8.4 Flow Switch

This menu allows the user to select if a flow switch signal will represent a flowing condition when a “closed” or “open” signal is seen for each systems flow switch input. User can also select if timers can work always or only with flow.

8.5 Contrast

This menu is used to adjust the contrast of the display.

8.6 Temperature Scale

This menu is used to select the type of temperature scale to display.

8.7 Network (if applicable)

The Network menu is used when a controller is being remotely communicated with either a local network connection or over the internet on the Web Advantage server.

```
>CONFIGURE NETWORK<
IP ADDRESS          HTTP REMOTE
IP MASK              FTP
GATEWAY              RESET
SERVER
HTTP LOCAL
```

NETWORK - This menu is used for setting up the remote WebAdvantage communications and is covered in a separate manual.

8.8 System Information

System information will identify the version of firmware installed in the controller along with the controller’s serial number.

9. History

The onboard history allows for viewing the history of the probe readings, relay activations, key-pad activity, calibrations, water meter hourly and daily logs and alarms for each system present. It is also where Notepad data is entered and reviewed. An initial overview page is displayed showing your current sample interval, the calculated number of days the unit can keep probe history for before losing the oldest. The number of sensor samples and relay/alarm events and Notepad entries currently stored is also displayed.

```
>HOME REVIEW<
SYSTEM 1      Sample Time: 5 MIN
               (Length 164.62 days)
               Sensor Samples
                 882
               Relay/Alarm Events
                 323
               Notepad Entries
```

NOTE: The history can be reset by going to the configure menu and entering a different sample interval. After the new sample interval has been set the onboard history is reset.

9.1 Viewing History

```
>HISTORY<
RELAY LOGS          WATER METER
ALARM LOGS
SENSOR HISTORY
EVENT LOG
NOTEPAD
```

RELAY LOGS - Relay activations displayed in a log form. Arrow up to advance through the log.
ALARM LOG - Alarm activations in log form.
SENSOR HISTORY - For selecting the parameters and viewing of a given probe reading's history in log or graph form.
EVENT LOG - Displays various activities.

9.2 Notepad Entries

```
>NOTEPAD: SYS 1 NOTE 1<
ENTER VALUE          Total Hardness
LOG                  8 Entries
GRAPH
                    517.2 Hrs to Alarm
```

The Notepad section under History is where the user goes to enter new values for the customized notepad items. Each individual notepad item's manually entered entries are stored in the units history and can be reviewed in log or graph form after 4 or more values have been entered.

11. Relays

```
>RELAYS<
STATUS
RESET
FORCE
```

STATUS - Allows for viewing accumulated relay ON times, temporary forcing relays ON or OFF or seeing which relay is on.

RESET - Allows the accumulated run time of a particular relay to be reset to zero.

FORCE - Allows a relay to be manually forced ON for a single event from 0-99 minutes. When the event is over the relay goes back to its normal automatic control.

```
>RELAY STATUS<
R01: ON              006:30:30
SYS1 COND BLEED
R02: OFF             008:56:35
SYS1 pH
R03: OFF-T           011:00:10
SYS1 TIMER1 INH
R04: OFF             007:00:00
SYS1 TIMER2 BIO1
R05: OFF             008:10:30
SYS1 TIMER3 BIO2
```

In the STATUS view the accumulated ON time is shown along with the main activator, custom name and current status:

ON = Relay on by relay activators

OFF = Relay off by normal logic

OFF-T = Relay off for daily max

OFF-D = Relay off for relay disabler

ON-A = Relay activated by activator other than main action

H-ON = Relay manually forced on

H-OFF = Relay manually forced off

VII. USB Functions

The XS is capable of transferring information using a FAT formatted USB drive. The XS has three main functions that it can perform using the USB.

- (1) Upgrade XS Firmware from USB Drive
- (2) Save XS Log Data to USB Drive
- (3) Clone User Settings between XS units.

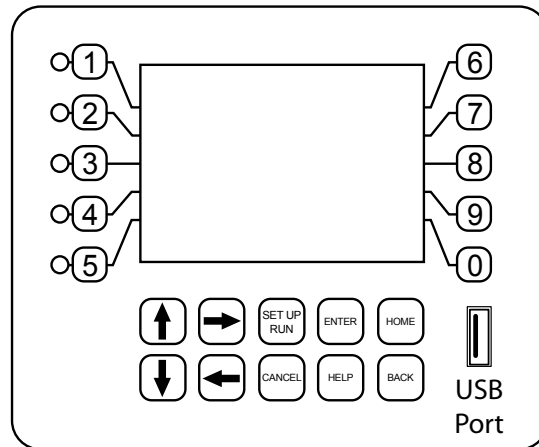

Upgrade XS Firmware

To upgrade the firmware on your XS, copy the updated software version to use to a USB drive. The file name should be “firmware.bin” Plug the USB drive containing this file into the XS USB connector. The USB DRIVE DETECTED pop-up window will appear. Use the up and down arrows to choose the “Update Firmware” selection. Press ENTER. It may take a few minutes for the update process to complete. Do not remove power or the USB drive during program updates. Once the firmware update is completed, the XS will automatically reboot. Once the system reboots, the USB DRIVE DETECTED screen will re-appear. Remove the USB Drive and this window will close.

Save XS Log Data to USB

History from an XS controller can be saved to a USB drive in one of two file formats (WebAdvantage or a generic Comma Separated). You can select what type will be transferred in the Configure menu under History there is a selection called Save Format. The WebAdvantage format is the default for then uploading history to WebAdvantage for cloud storage and graphing. Change to Comma Separated if using with Excel.

To transfer the contents of the XS history logs to the USB drive, plug a USB drive in to the XS USB port. The USB DRIVE DETECTED pop-up window will appear. Use the up and down arrows to choose the “History->USB” selection. Press ENTER. It may take a few minutes for the process to complete. Status will be displayed on the screen to show the percent completed of each log record type. Once the log is completely stored, the pop-up window will close. The USB drive will now contain a file named “LOG.TXT”.

Cloning an XS

The XS has the ability to copy the User Settings from one XS to another. This process is referred to as cloning. To clone your XS, insert the USB drive into the XS with settings you want to save for cloning. Once the USB DRIVE DETECTED pop-up window appears, use the up and down arrows to choose the “Config->USB” selection. Press ENTER. The User settings will be saved to the USB drive under the file name “CONFIG.BIN”. The pop-up window will close when the copy is completed.

Take the USB drive and plug it in to the XS that you would like to copy the User Settings to. When the USB DRIVE DETECTED window appears, use the up and down arrow keys to choose the “USB->Config” selection. Press ENTER. The User Data will be loaded in to the XS from the USB drive. Once the pop-up window closes, the cloning is completed.

-  **Warning:**
1. Not all customized names are saved.
 2. USB drives must be FAT formatted to work correctly.

VIII. Troubleshooting & Maintenance

The Advantage Glycol Feeder is designed for many years of trouble free operation. Should a problem occur, refer to the following chart to help identify the problem. If replacement is required, follow the procedures listed in the Warranty and Factory Service portion of this manual.

NO POWER TO UNIT, POWER PRESENT AT RECEPTICAL

This happens if the power cord is tripped over or gets caught and pulled by accident.

1. First disconnect plug from live receptacle.
2. Next you will need Phillips #2 driver to remove face plate
3. Face plates are snug fitting and it may require a small standard driver in the slot at the side of the panel to get it moving.
4. Once the panel is free, let it hang down out of view of the enclosure opening.
5. Locate the connector inside of the enclosure for power this is a GREEN three (3) terminal with screw downs.
6. Reconnect to RELAY / POWER BOARD (Drawing on page 24)
7. Before replacing the panel, do a quick visual of all connections and wiring to ensure no other damage has occurred.
8. Replace panel and secure.
9. Plug in power cord and proceed with Start-up.
10. Your power issue was not corrected.
Record Model /Serial Numbers and Call Customer Service 1 (800) 743-7431.

PUMP WILL NOT RUN. BLOWS FUSE WHEN ENERGIZED

This usually is cause by having some debris in the gears of the pump.

1. Before removing the pump head loosen the six head screw a half turn.
2. Replace blown fuse and energize pump.
3. If this corrects issue, de-energize pump, tighten six screw, proceed with Star-Up.
4. If this doesn't solve issue the pump head should be removed and inspected for particles.
Because of tolerance in the gears it doesn't take a big particle to freeze the motor.
5. Before removing the head be sure to close the suction line valve.
6. It is not necessary to remove tubing.
7. Remove the six (6) head screws.
8. Be aware of the seal ring as you remove the head.
9. With your fingers turn the gears to insure that the motor is not seized.
10. If the gears turn freely you may power the pump for a short period to prove rotation.
11. If the gears do not turn freely, but they do turn, try powering the pump for short period.
12. If there is rotation. Replace the Pump Head, being careful to align gasket.
13. If the pump motor is frozen, it is best to replace the entire pump.

PUMP DOES NOT RUN WHEN INDICATOR IS ILLUMINATED

1. Check fuse and that the fuse holder cap is secure
2. Check pump wiring.
3. Check level of fluid / depth of level wand.
4. Does power down and up fix issue?
 - If Yes, there is a limit time set in the PRESSURE SET Menu.
 - If No, the most likely cause is a loose wire inside of control enclosure. (See NO POWER TO UNIT, POWER PRESENT AT RECEPTICAL 1 thru 10 above)

PUMP DOES NOT SHUT OFF WHEN TANK IS EMPTY

1. First verify that in LEVEL SET Menu that level one(1) is active.
2. Level is not Active, press enter to change to active. This should end issue.
3. Level is Active. Disconnect level wand connection. Alarm should sound and pump stop.

- If Yes, inspect end of level wand for debris or damage, replace if needed. (The float at bottom of the wand should have free movement, up and down.
 - If No, inspect wire for damage. If no damage visible inspect internal wiring. (See NO POWER TO UNIT, POWER PRESENT AT RECEPTICAL 1 thru 10 above)
4. If no resolution is found, record Serial / Model numbers and call customer service

LOW LEVEL ALARM STAYS ON

1. Disconnect level wand connection and short across connectors with screw driver. (this is low voltage and not dangerous)
2. This turns off the alarm. There is a problem with the wand itself.
3. Inspect the float end of the level wand.
4. If the float is free moving replace wand.
5. Shorting the connector does not turn off alarm. Inspect internal wiring. (See NO POWER TO UNIT, POWER PRESENT AT RECEPTICAL 1 thru 10 above)
6. Still no resolution record Model / Serial numbers and call customer service.

Maintenance

Being a self-contained unit with a sealed fractional horsepower motor vary little maintenance is required.

1. Depending on your environment will gauge how often the bowl strainer will need cleaning.
2. The Tank should be inspected occasionally for trash and or debris.
3. Occasional running of Your pump or pumps will insure their longest life.

IX. Parts List

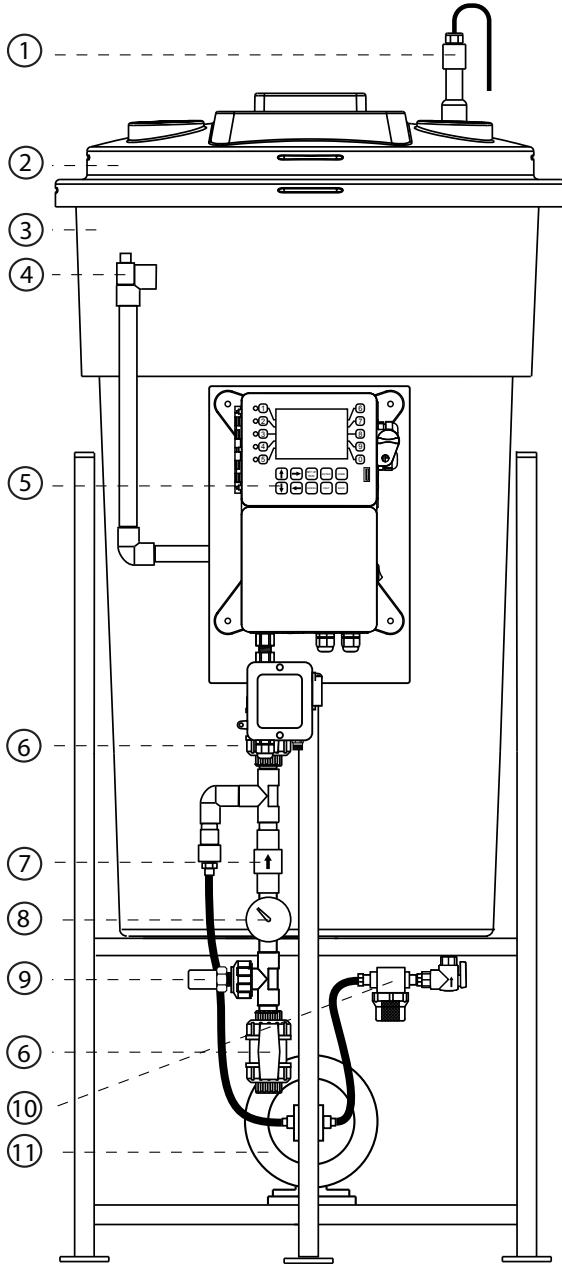

Parts List

1. Level wand for 30 gl = **ALL-S30**; 55 gl = **ALL-S42**
2. Tank lid for 30 gl = **LID-30-C1D**; 55 gl = **LID-55-C1D**
3. Tank for 30gl = **AGF-APCT-30**; for 55 gl = **AGF-APCT-55**
4. Pressure relief valve = **AGF-PRV**
5. Controller (for selection A)
6. Isolation valve = **BV-3/4** for PVC; **GV-3/4** for copper
7. Back check = **CKV-3/4PP** for PVC; **CKV-3/4B** for copper
8. Pressure gauge = **AGF-PG**
9. Pressure transducer = **AGF-PTD**
10. Suction shut-off and strainer assembly = **AGF-SUCTION**
11. Pump = **991F41** (for selection 1); **992MJ07** (for selection 2)

Note: This list covers most of our popular models.
For models not covered, consult factory.

No. 530

Calibrated Pressure Relief Valve

Features

- A calibrated adjustment feature for setting the valve to the relief pressure required.
- All Bronze construction
- All stainless steel springs

Specifications

Sizes $\frac{1}{2}$ " and $\frac{3}{4}$ " (15 and 20 MM)

Inlet (bottom) is male threaded, NPT

Outlet (side) is female threaded, NPT.

Design

Wats No. 530 is spring operated bronze relief valve designed to be used as protection against excessive pressure of water, oil or air.

This device is designed for emergency safety relief and shall not be used as an operation control.

Buna-N disc on machined body seat.

Application

Ideally suited as a by-pass thermal expansion relief valve.

There are a wide variety of applications where the valve is used as a protective device. One such application would be on various pipelines.

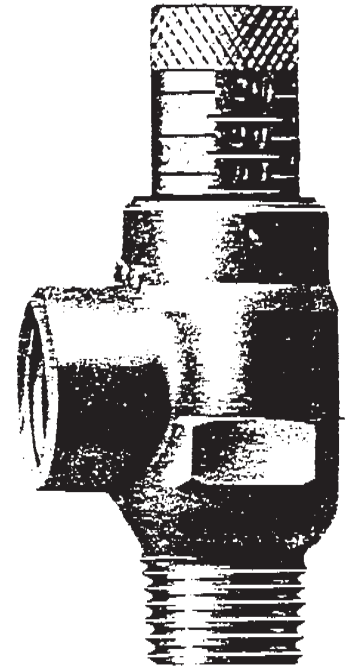

Parts List

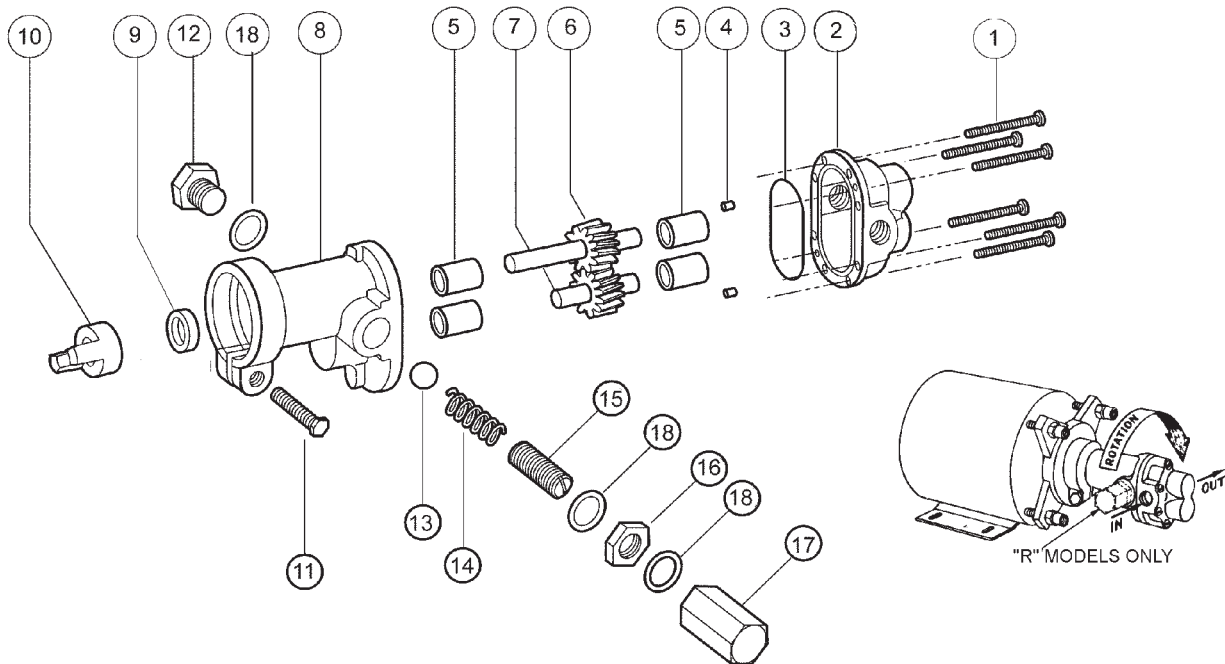

	1	2	3*	4	5*	6*	7*	8	9#	10	11	12	13	14	15	16	17	18
	Screw	Body	O-Ring	Dowel Pin	Bearing	Drive Gear Assy	Idle Gear Assy	Cover	Lip Seal	Coupling	Screw	Plug Nut	Ball	Spring	Adj. Screw	Locknut	Bypass Nut	Fiber Washer
Pump No.	6 Req'd	1 Req'd	1 Req'd	2 Req'd	4 Req'd	1 Req'd	1 Req'd	1 Req'd	1 Req'd	1 Req'd	1 Req'd	1 Req'd	1 Req'd	1 Req'd	1 Req'd	1 Req'd	1 Req'd	3 Req'd
N991	7733	9300NB5N	9797-033	8885	5024	32149	32110	9303NN2N	5007	5604	5595	N/A	N/A	N/A	N/A	N/A	N/A	N/A
N991R	7733	9300NB5N	9797-033	8885	5024	32149	32110	9303NN2B	5007	5604	5595	1838	5803	1840	5237	5240	5239	6533

#Seal #5007 is Standard Buna N, #7580 is Viton(R)**-Teflon (R)**

*Repair Kit contains items 3, 5, 6, 7 & 9. Repair Kit for N991(R) is #10640.

VARIATIONS

Pump No.	g ^{1,2}	
	Lip Seal	Repair Kit ²
N991S5	7580	11318
N991RS5	7580	11318

Adapter Kit	Kit Number	Description
M	10562	48 Frame
N	10816	56 Frame
P	11722	S56 Frame
Q	11331	56C Frame (to 3/4 HP)
F	11332	IEC71
----	----	Adapterless- Modified 48

DIMENSIONS

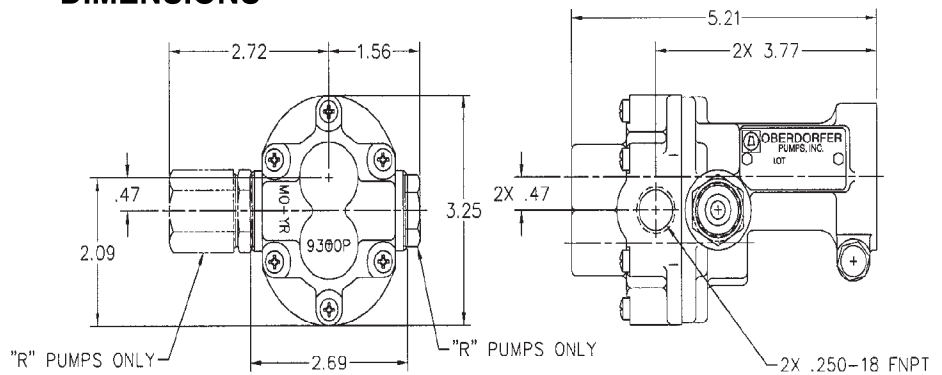

*Viton® or equivalent FKM will be used.

Viton® is a registered trademark of DuPont Dow Elastomers.

*Teflon® or equivalent PTFE will be used. Teflon® is a registered trademark of DuPont.

Specifications are subject to change without notice.

X. Wiring Diagrams

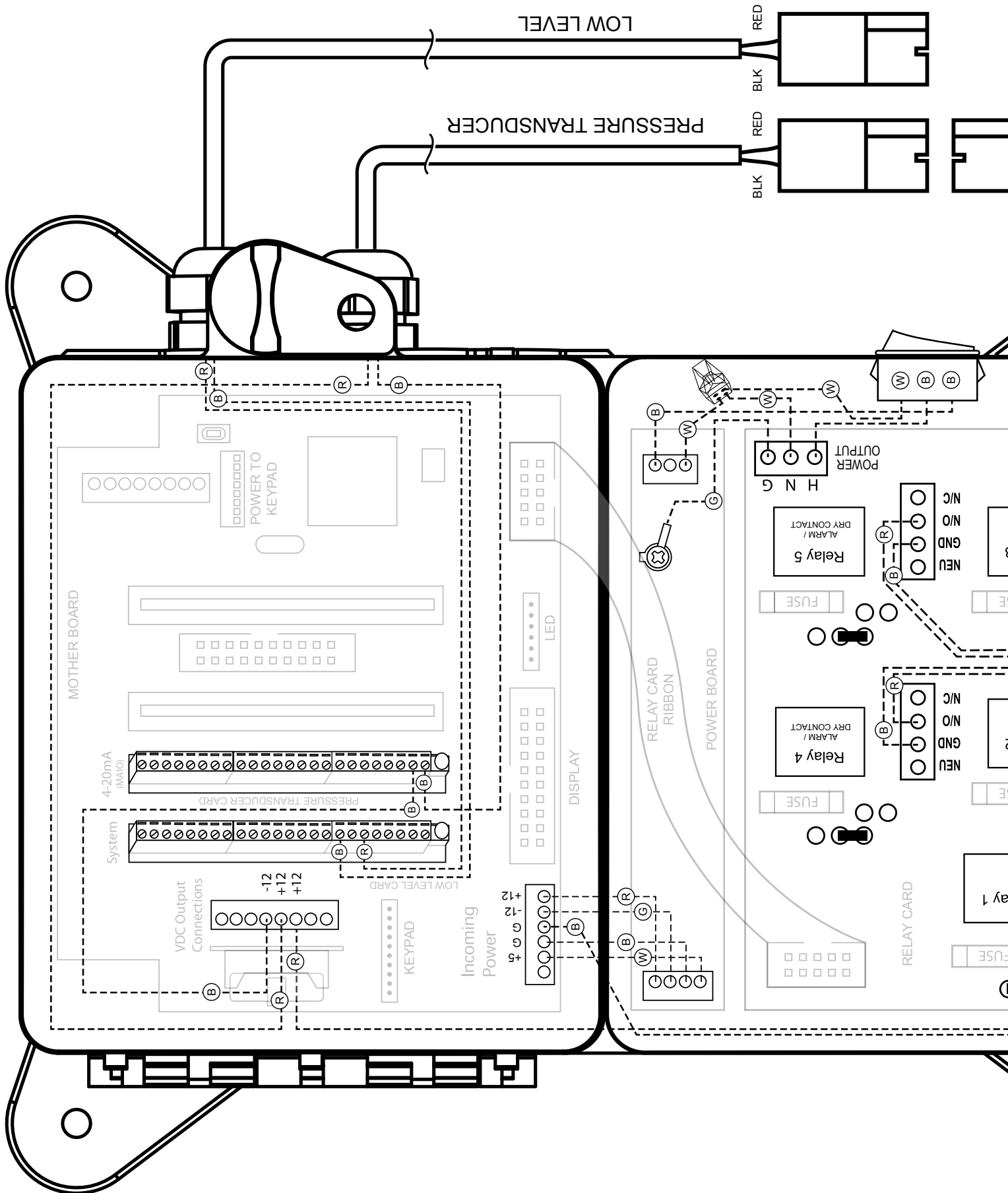

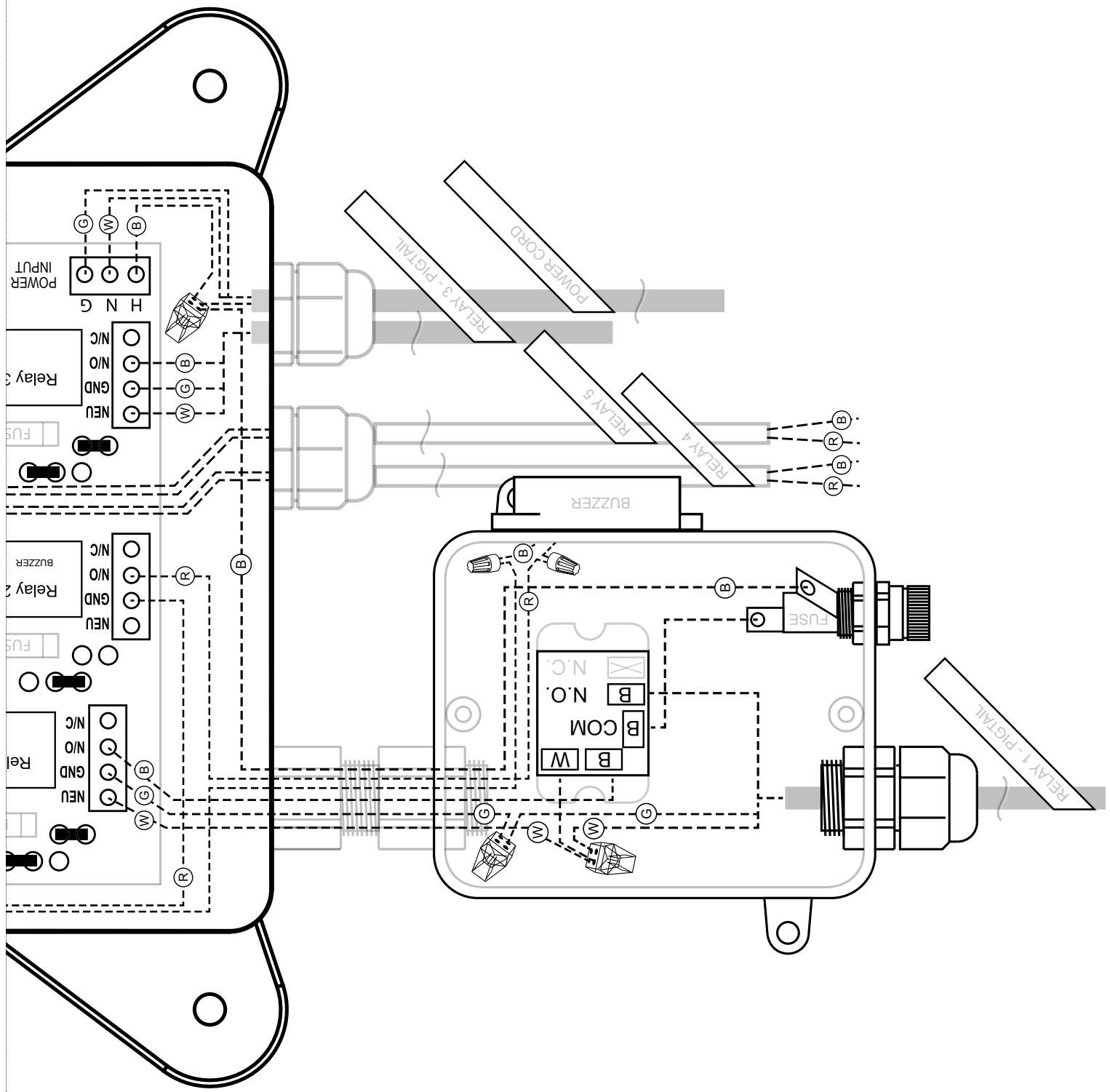
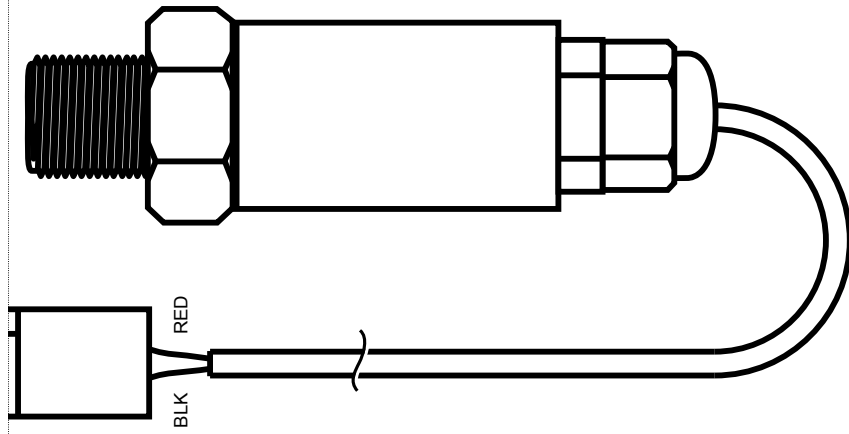

XI. Manufacturer's Product Warranty

Advantage Controls warrants units of its manufacture to be free of defects in material or workmanship. Liability under this policy extends for 24 months from date of installation. Liability is limited to repair or replacement of any failed equipment or part proven defective in material or workmanship upon manufacturer's examination. Removal and installation costs are not included under this warranty. Manufacturer's liability shall never exceed the selling price of equipment or part in question. Advantage disclaims all liability for damage caused by its products by improper installation, maintenance, use or attempts to operate products beyond their intended functionality, intentionally or otherwise, or any unauthorized repair. Advantage is not responsible for damages, injuries or expense incurred through the use of its products.

The above warranty is in lieu of other warranties, either expressed or implied. No agent of ours is authorized to provide any warranty other than the above.

30 Day Billing Memo Policy

Advantage Controls maintains a unique factory exchange program to ensure uninterrupted service with minimum downtime. If your unit malfunctions, call 1-800-743-7431, and provide our technician with Model and Serial Number information. If we are unable to diagnose and solve your problem over the phone, a fully warranted replacement unit will be shipped, usually within 48 hours, on a 30 Day Billing Memo.

This service requires a purchase order and the replacement unit is billed to your regular account for payment.

The replacement unit will be billed at current list price for that model less any applicable resale discount. Upon return of your old unit, credit will be issued to your account if the unit is in warranty. If the unit is out of warranty or the damage not covered, a partial credit will be applied based upon a prorated replacement price schedule dependent on the age of the unit. Any exchange covers only the controller or pump. Electrodes, liquid end components and other external accessories are not included.

Reference Chart % Propylene Glycol

Weight % Propylene Glycol	Volume % Propylene Glycol	Freeze Point°F	Refractive Index N _D 77°F	Degree Brix	Boiling Point °F @760MM Hg
20	19.4	19.9	1.3565	15.4	213°F
21	20.4	19.0	1.3575	16.0	
22	21.4	28.0	1.3596	16.7	
23	22.4	17.0	1.3598	17.4	
24	23.4	16.0	1.3611	18.4	
25	24.4	15.0	1.3621	18.8	214°F
26	25.3	14.0	1.3632	19.6	
27	26.4	13.0	1.3643	20.2	
28	27.4	12.0	1.3654	20.8	
29	28.4	11.0	1.3664	21.4	
30	29.4	9.1	1.3674	22.0	216°F
31	30.4	8.0	1.3685	22.7	
32	31.4	7.0	1.3700	23.6	
33	32.4	6.0	1.3714	24.4	
34	33.5	4.0	1.3729	25.3	
35	34.4	3.0	1.3742	26.1	217°F
36	35.5	1.0	1.3755	26.9	
37	36.5	0	1.3765	27.5	
38	37.5	-2.0	1.3775	28.0	
39	38.5	-4.0	1.3785	28.5	
40	39.6	-5.0	1.3796	29.1	219°F
41	40.6	-7.0	1.3806	29.6	
42	41.6	-9.0	1.3816	30.2	
43	42.6	-11.0	1.3826	30.7	
44	43.7	-13.00	1.3837	31.3	
45	44.7	-15.0	1.3847	31.8	220°F
46	45.7	-17.0	1.3857	32.4	
47	46.8	-19.0	1.3868	33.0	
48	47.8	-22.0	1.3878	33.5	
49	48.9	-25.0	1.3889	34.1	
50	49.9	-29.0	1.3899	34.7	222°F
51	50.9	-31.0	1.3911	35.5	
52	51.9	-33.0	1.3922	35.9	
53	53.0	-37.0	1.3936	36.6	
54	54.0	-40.00	1.3947	37.2	
55	55.0	-43.6	1.3961	38.0	
56	56.0	-46.0	1.3968	38.4	
57	57.0	-50.0	1.3991	39.1	
58	58.0	-53.0	1.3991	39.6	
58	59.0	-57.0	1.4002	40.3	
60	60.0	-60.0	1.4012	40.7	225°F

Reference Chart % Ethylene Glycol

Weight % Ethylene Glycol	Volume % Ethylene Glycol	Freeze Point°F	Refractive Index N _D 77°F	Degree Brix	Boiling Point °F @760MM Hg
20	18.1	17.0	1.3525	13.0	216°F
21	19.2	16.5	1.3536	13.7	
22	20.1	16.0	1.3546	14.3	
23	21.0	14.0	1.3555	14.8	
24	22.0	13.0	1.3565	15.4	
25	22.9	12.0	1.3575	16.0	218°F
26	23.9	11.0	1.3585	16.6	
27	24.8	10.0	1.3590	17.0	
28	25.8	9.0	1.3606	17.7	
29	26.7	8.0	1.3615	18.5	
30	27.7	7.0	1.3625	19.0	220°F
31	28.7	5.0	1.3636	22.8	
32	29.6	4.0	1.3645	23.4	
33	30.6	2.0	1.3645	20.9	
34	31.6	1.0	1.3666	21.5	
35	32.6	0.0	1.3677	22.2	221°F
36	33.5	-1.0	1.3686	22.8	
37	34.5	-3.0	1.3696	23.4	
38	35.5	-4.0	1.3707	24.0	
39	36.5	-5.0	1.3718	24.6	
40	37.5	-8.0	1.3728	28.2	224°F
41	38.5	-9.0	1.3729	29.1	
42	39.5	-11.0	1.3750	26.5	
43	40.5	-13.0	1.3760	27.2	
44	41.5	-15.0	1.3770	27.7	
45	42.5	-17.0	1.3780	28.2	225°F
46	44.0	-20.0	1.3796	29.1	
47	45.0	-22.0	1.3806	29.6	
48	46.0	-24.0	1.3818	30.2	
49	47.1	-26.0	1.3828	30.8	
50	48.0	-28.0	1.3837	31.3	227°F
51	49.1	-31.0	1.3848	31.9	
52	50.1	-35.0	1.3858	32.5	
53	51.2	-36.0	1.3869	33.1	
54	52.2	-38.0	1.3880	33.6	
55	53.2	-43.0	1.3889	34.1	227°F
56	54.3	-45.0	1.3968	38.4	
57	55.3	-50.0	1.3909	35.2	
58	56.3	-52.0	1.3919	35.7	
58	57.4	-54.0	1.3930	36.4	
60	68.4	-58.4	1.3939	36.8	230°F

Get the Advantage in Water Treatment Equipment

Advantage Controls can give you the *Advantage* in products, knowledge and support on all of your water treatment equipment needs.

- Cooling Tower Controllers
- Boiler Blow Down Controllers
- Blow Down Valve Packages
- Solenoid Valves
- Water Meters
- Chemical Metering Pumps
- Corrosion Coupon Racks
- Chemical Solution Tanks
- Solid Feed Systems
- Feed Timers
- Filter Equipment
- Glycol Feed Systems
- Pre Fabricated Systems

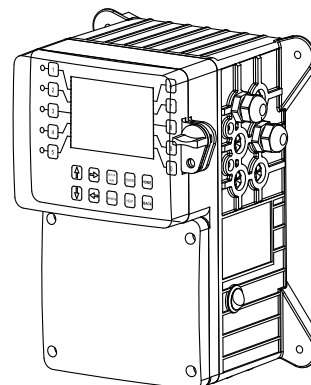
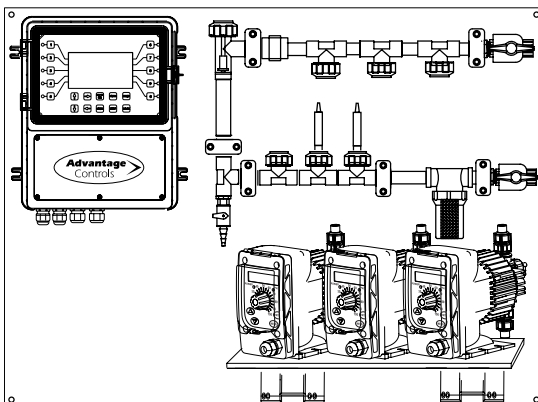
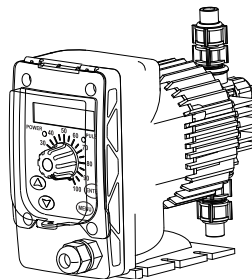
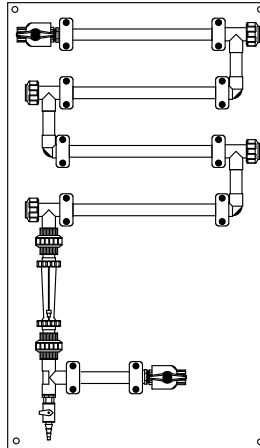
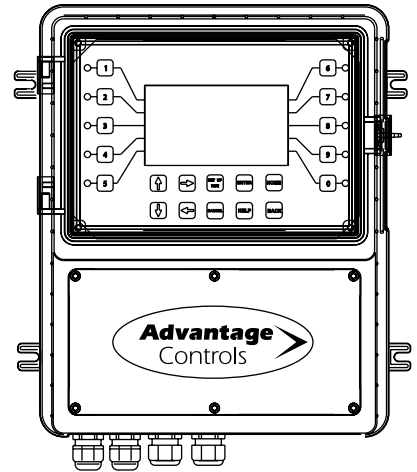
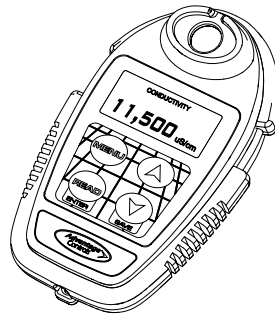

Get the Advantage

