

---

# USER MANUAL

---

## 2.5 and 5 Gallon Chemical Transport Jug

English

---

READ ALL INSTRUCTIONS BEFORE OPERATING EQUIPMENT

Model Number Chart

	2.5 gallon	5 gallon	Black Locking Cap (DO NOT use with acids)	Black Cap	Red Cap	Blue Cap	1/4 and 3/8 inch Suction Line with Filter	SS Rack
ITEM NUMBER	(J2.5)	(J5)	(BKL)	(BK)	(RD)	(BL)	(S)	(R)
EXAMPLE	Jug capacity		Cap options					
J2.5BKSR	x			x			x	x
J5RDS		x			x		x	

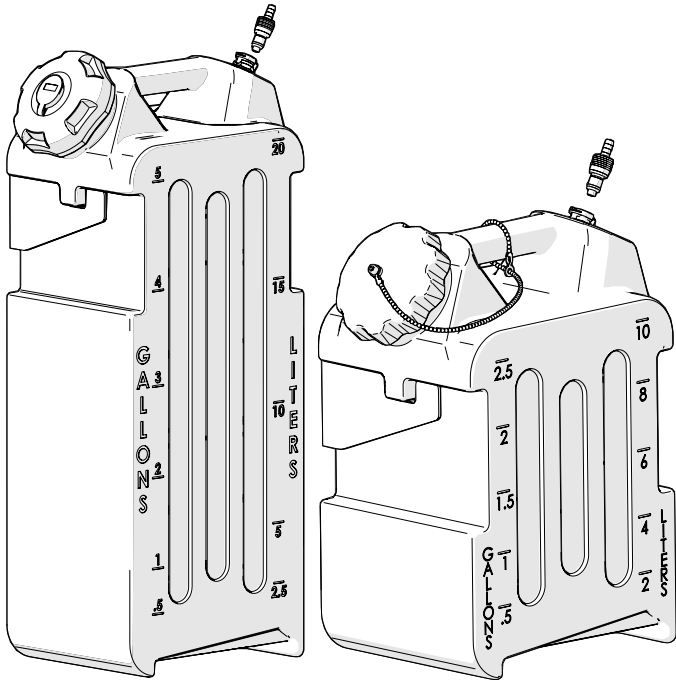

## READ ALL INSTRUCTIONS BEFORE OPERATING EQUIPMENT



# WARNING



**Read this manual completely and understand the unit before operating or servicing it.**

- Always wear appropriate personal protective equipment (PPE) when operating or servicing unit.
- Always follow all chemical safety precautions and handling instructions provided by the chemical manufacturer and Material Safety Data Sheet (MSDS).
- Always flush the unit with fresh water for 5 minutes when switching from an alkaline to an acid or an acid to an alkaline.
- Do not exceed a fluid temperature of 100°F (37°C).
- **DO NOT USE ACIDS WITH LOCKING CAP.**

### PROTECT THE ENVIRONMENT

Please dispose of packaging materials, old machine components, and hazardous fluids in an environmentally safe way according to local waste disposal regulations.



Always remember to recycle.

\*Specifications and parts are subject to change without notice.

### Dimensions:

#### 2.5 Gallon Jug:

Length ..... 10 in (254 mm) approximately  
Width ..... 8 in (203 mm) approximately  
Height ..... 15 in (381 mm) approximately  
Weight:  
(Empty) ..... 2.5 lbs (1.1 kg) approximately  
(Full) ..... 24.5 lbs (11.1 kg) approximately

#### 5 Gallon Jug:

Length ..... 10 in (254 mm) approximately  
Width ..... 8 in (203 mm) approximately  
Height ..... 24.5 in (622 mm) approximately  
Weight:  
(Empty) ..... 6 lbs (2.7 kg) approximately  
(Full) ..... 49 lbs (22.2 kg) approximately

### Requirements:

Chemical Requirements: Follow all instructions from chemical manufacturer and Material Safety Data Sheet (MSDS).

### Acceptable Products:

#### Jug with Non-Locking Cap:

Alkaline cleaners, Caustic cleaners, Sanitizers, D-Limonene, Chlorine, and Acids

**DO NOT USE: All hydrocarbons**

#### Jug with Locking Cap:

Alkaline cleaners, Caustic cleaners, Sanitizers, D-Limonene, and Chlorine

**DO NOT USE: All hydrocarbons or ACIDS**

## READ ALL INSTRUCTIONS BEFORE OPERATING EQUIPMENT

### PARTS DIAGRAMS

#### JUG BODY

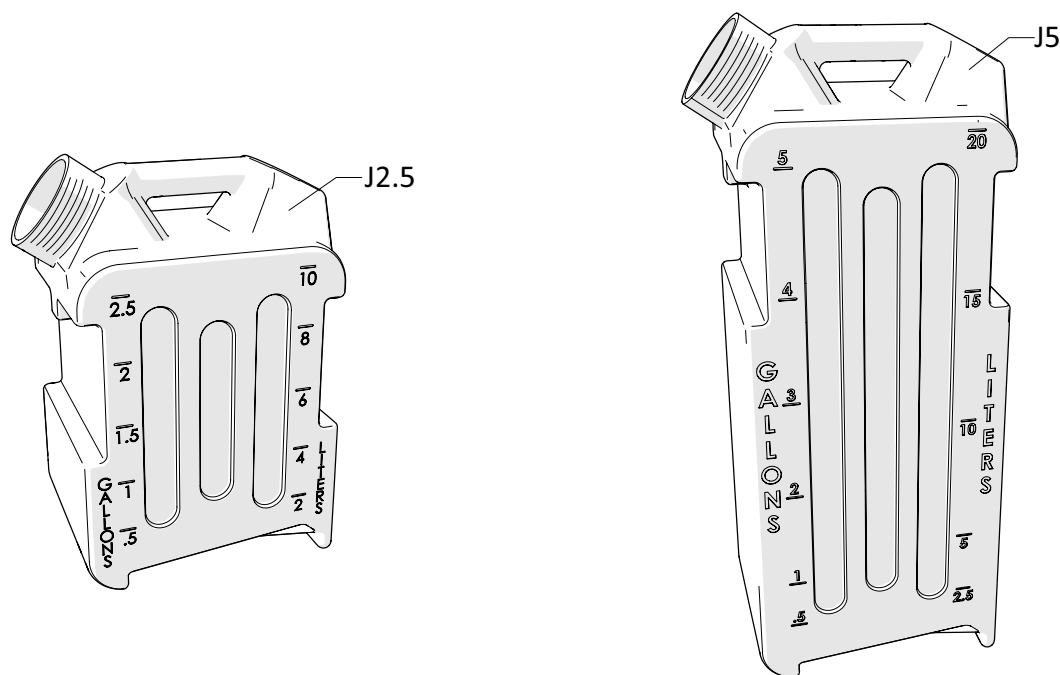

#### NON-LOCKING CAP FOR JUGS WITHOUT SUCTION FITTINGS

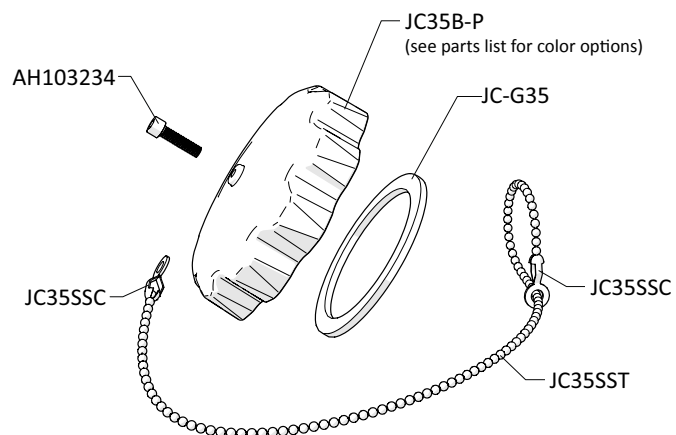

#### NON-LOCKING ONE-WAY VENTED CAP FOR JUGS WITH SUCTION FITTINGS

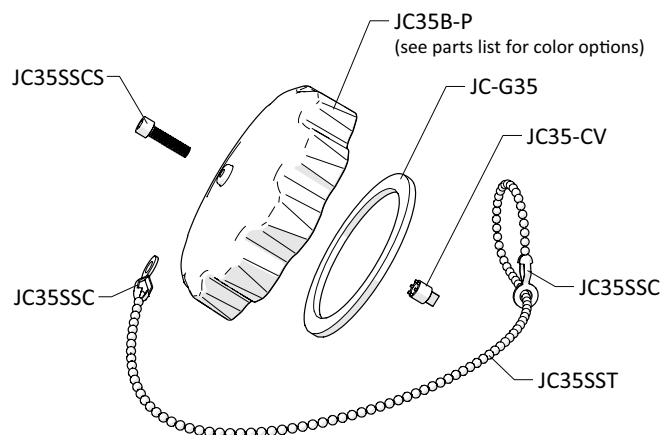

## READ ALL INSTRUCTIONS BEFORE OPERATING EQUIPMENT

### PARTS DIAGRAMS (CONTINUED)

#### LOCKING ONE-WAY VENTED CAP ITEM NUMBER: JC35L

**\*\*NOT COMPATIBLE WITH ACIDS!\*\***

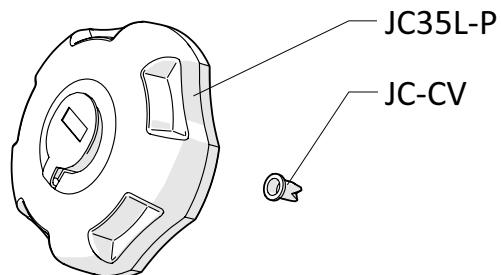

#### STAINLESS STEEL JUG RACK

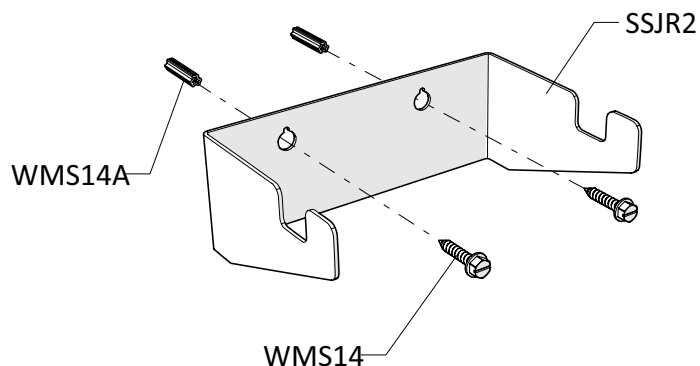

#### SUCTION FITTINGS AND DRAW TUBE

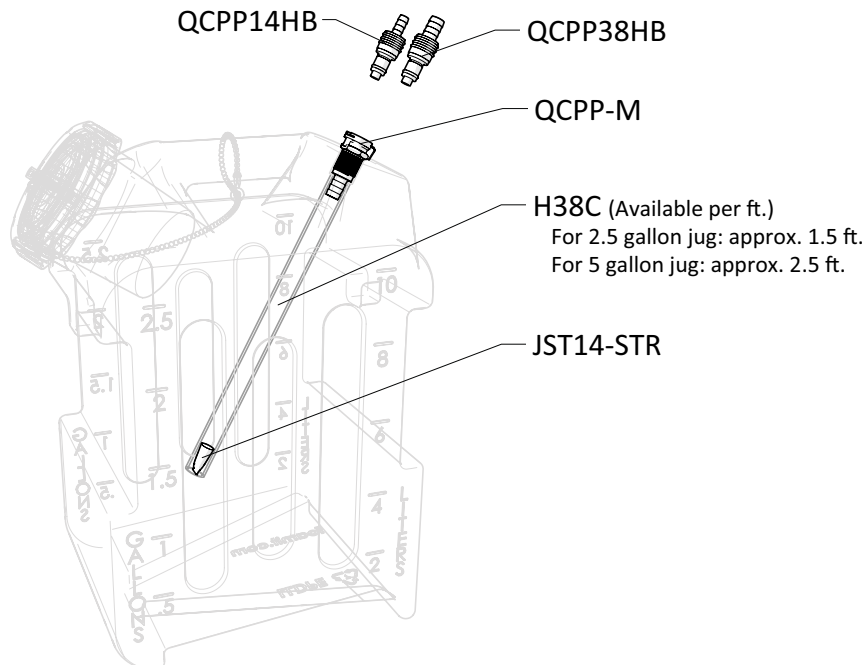

## READ ALL INSTRUCTIONS BEFORE OPERATING EQUIPMENT

ITEM NUMBER	DESCRIPTION
AH103234	10-32 X 3/4 SOC CAP SCR 18-8 PLN
H38C	3/8in CLEAR PVC TUBING - Available per ft.
J2.5	2.5 GALLON POLYETHYLENE JUG
J5	5 GALLON POLYETHYLENE JUG
JC35B	BLACK 3.5 INCH ONE WAY VENTED CAP ASSEMBLY - INCLUDES CAP, GASKET, AND CHECK VALVE
JC35B-P	BLACK 3.5 INCH CAP - POLYPROPYLENE
JC35-CV	EPDM CHECK VALVE FOR NON LOCKING JUG CAP
JC-G35	JUG CAP GASKET 3.5 INCH CAP VITON
JC35BL-P	BLUE 3.5 INCH CAP - POLYPROPYLENE
JC35RD-P	RED 3.5 INCH CAP - POLYPROPYLENE
JC35L	3.5 INCH NYLON ONE WAY VENTED CAP ASSEMBLY - INCLUDES CAP WITH LOCK AND CHECK VALVE
JC35L-P	3.5 INCH NYLON CAP WITH LOCK
JC-CV	JERRY CAN CAP SILICONE CHECK VALVE
JC35SSC	304 SS END COUPLING FOR SIZE 8-10, ROUND BEAD CHAIN
JC35SSCS	VENTED 18-8 SS SOCKET HEAD CAP SCREW, 10-32 THREAD, 3/4 INCH LENGTH .046 VENT DIAMETER
JC35SST	ROUND BEAD CHAIN, TYPE 304 SS
JST14-STR	DRAW TUBE STRAINER - SS 304 50.009 3/8in ID X 1in w/ BAGFOLD
QCPP14HB	Polypropylene In-line hose barb valved plug for 1/4 I.D. tube
QCPP38HB	Polypropylene In-line hose barb valved plug for 3/8 I.D. tube
QCPP-M	Polypropylene panel mount valved hose barb socket for 3/8 I.D. tube.
SSC38	WORM GEAR CLAMP, S/S (.25-.63)
SSJR2	SS RACK TO MOUNT CHEMICAL TRANSPORT JUG
WMS14	14 X 1 1/4 HEX W/H SMS SLOTT, S/S
WMS14A	5/16 X 1 1/2 STRAIGHT PLASTIC ANCHOR